

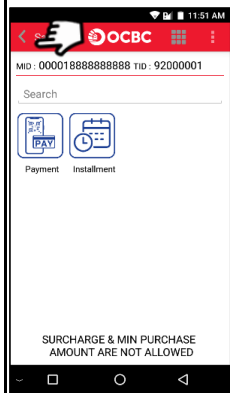

Payment Transaction Procedures

Quick Reference Guide
Model: N5

SALES (PRE-AUTH)



1. Tap on (<) sign

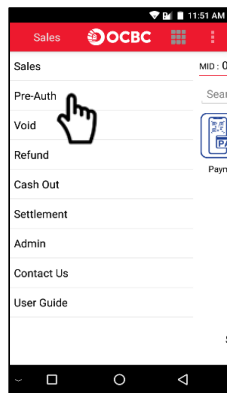

2. Select **Pre-Auth**

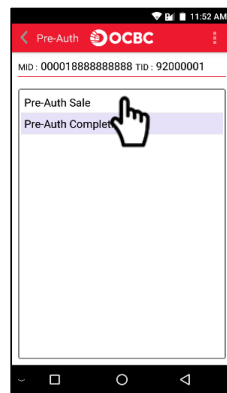

3. Select **Pre-Auth Sale**

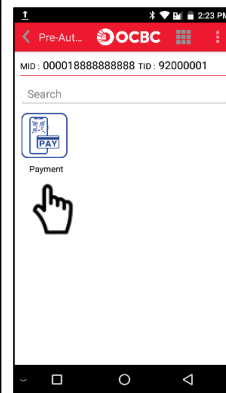

4. Select **Payment**

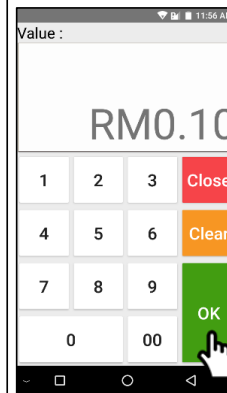

5. Key in Pre-Auth sale amount and press OK

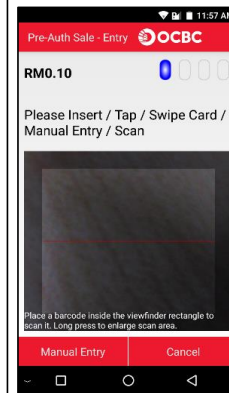

6. **WAVE** or **INSERT** payment card to the terminal

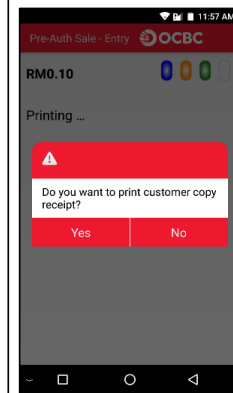

7. Select **YES** for the customer copy receipt

SALES (PRE-AUTH COMPLETION)

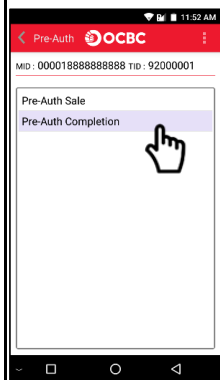

1. Select **Pre-Auth Completion**

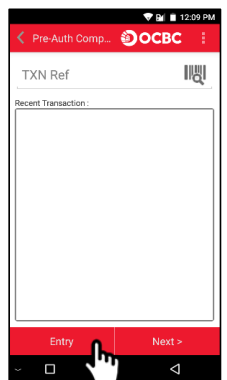

2. Tap on **Entry**

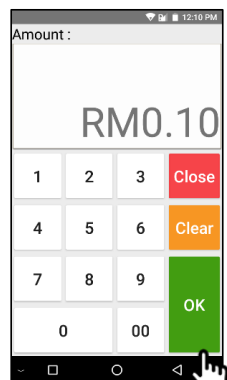

5. Key in Pre-Auth Completion sale amount and press OK

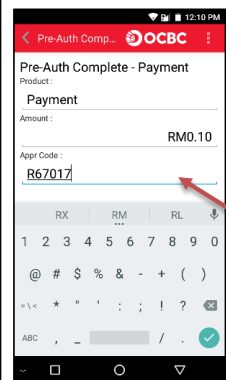

5. Key in **Approval Code**

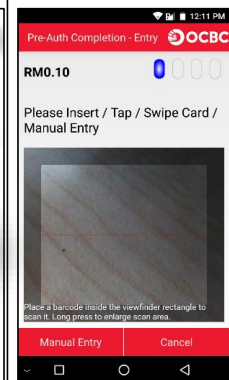
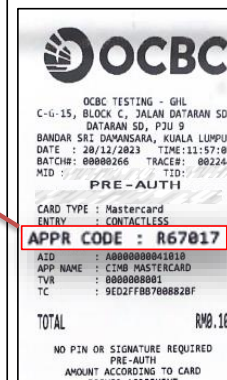

6. **WAVE** or **INSERT** payment card to the terminal

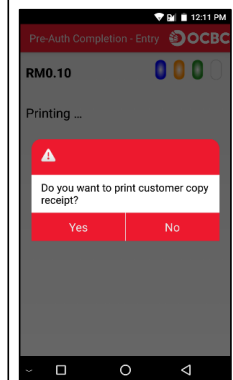

7. Select **YES** for the customer copy receipt